

Available now from  **TRIMFORM**

T: 01480 461103 • E: info@trimformfabs.co.uk



Gemello[®]
WARRANTIED TWIN-SKIN SYSTEM



Gemello[®] Warrantied Twin-Skin Cladding System

www.sigbuildingsolutions.co.uk

The Gemello® twin skin system is a comprehensive self-supporting roof and wall cladding solution.



The wide range of external cladding profiles are available in an extensive range of finishes and colours enabling designers to create modern, visually-engaging buildings.

This design flexibility of the Gemello® twin skin system makes it suitable for use on projects across many market sectors including industrial, retail, office, health, education, leisure and agricultural.

The Gemello® systems are suitable for cladding steel framed buildings and can be fully integrated with both modern and traditional methods of construction.

Gemello® systems provide thermal, structural and acoustic properties along with tested fire resistance.

The Gemello® system can be tailored to suit the aesthetic and design requirements of a building application.

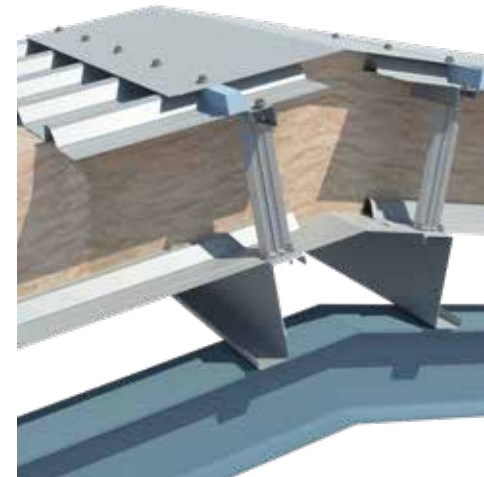

The Gemello® cladding range includes 6 trapezoidal roof profiles, 8 wall profiles and 6 internal liner profiles, all with various cover widths.

All roof profiles are classed non-fragile to the materials standard in the Advisory Committee for Roof Safety "Red Book" ACR[M]001:2019: 6th Edition.

The thermal performance comes from an insulation cavity formed by an engineered bar and bracket spacer system with the void filled using non-combustible mineral or glass fibre insulation. Thermal U-Values as low as 0.11 w/m²K are available, please see the table on page 11 or contact the technical team for further information.

Typical Roof System Build-Up

0.7mm coated galvanised outer sheet

Bar and bracket spacer system

Insulation quilt

0.7mm coated galvanised steel liner

Optional VCL if the liner cannot be robustly sealed

Roof System



Typical Wall System Build-Up

0.5mm coated galvanised outer sheet

Bar and bracket spacer system

Insulation quilt

0.4mm coated galvanised steel liner

Wall System



accessories

A wide range of accessories are manufactured and supplied to complete a Gemello® roofing and cladding project.



Rooflights

Site assembled in-plane GRP rooflights are available in a range of Gemello® roof profiles, providing natural daylighting, reducing the need for artificial light.

Gutters

A complete range of gutters and rainwater goods can be manufactured and supplied to meet the specific requirements of an individual project.

Gutters are fabricated in a variety of materials including aluminium, pre-galvanised steel, pre-coated steel with a PVC finish, and membrane lined gutters, to suit the designer's needs.

Insulated membrane lined gutters are available for designs where the gutter form part of the insulated building envelope.

Flashings

Flashings can be manufactured in range of finishes and designs to suit a customer's design.

Fasteners, Fillers and Sealants

All fasteners, spacer systems, sealants and profiled fillers are to be supplied by SIG Building Solutions to comply with the Gemello® system guarantee.

materials

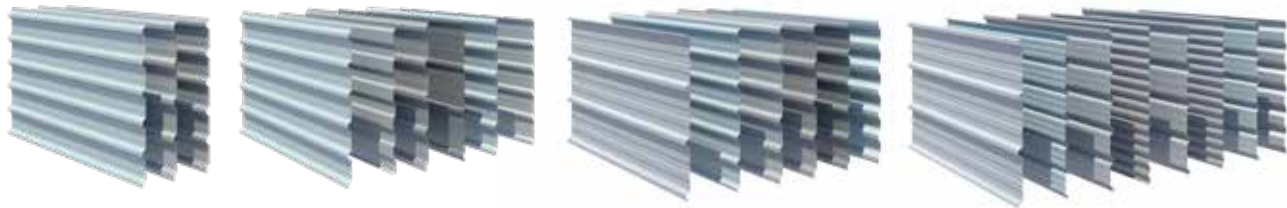

Coating	Thickness	Applications
Colorcoat HPS200 Ultra®	200µm	Suitable for roofs and walls in industrial and coastal/marine environments.
Plastisol Leathergrain	200µm	High performance, durable coating at a competitive price.
Liner	15µm	Suitable for lining roofs and walls. Not suitable for polluted or high humidity environments.
Colorcoat Prisma®	40-65µm	Suitable for roofs and walls in industrial and coastal/marine environments where metallic colours are required.

Roof Liner Profiles

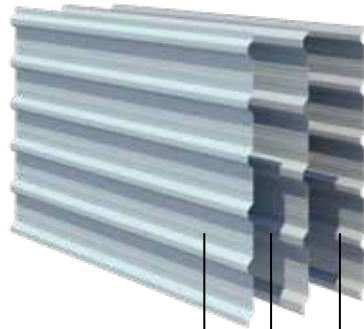

Roof Inner

AS30/1000 L

TF32-4P R

URP32/1000 L

Wall Liner Profiles

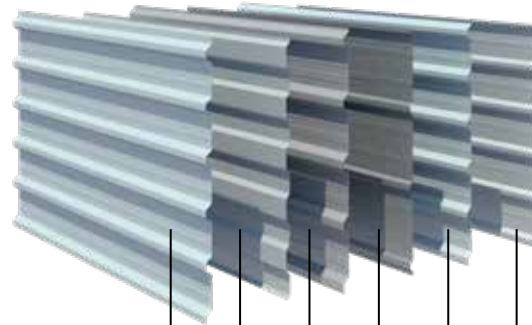

Wall Inner

AS30/1000 L

AS20/1000 WL

TF32-4P L

TF17/1000 WL

URP32/1000 L

URP20/1000 WL

external profiles

Roof Profiles

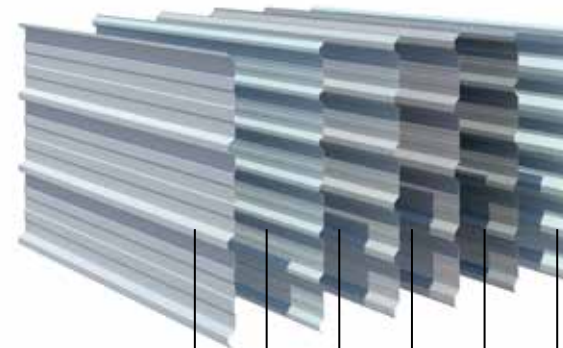

Roof Outer

AS35/1000 R

AS24/1000 R

AS30/1000 R

TF32-4P R

URP1000/32 R

URP1000/34 R

Wall Profiles

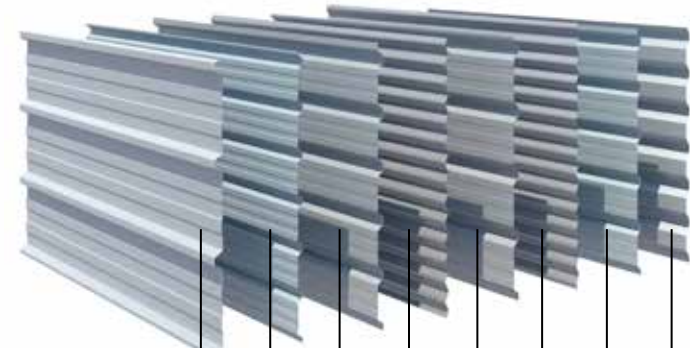

Wall Outer

AS35/1000 W

AS24/1000 W

AS30/1000 W

AS18/990 S

TF32-4P W

TF18/1067 S

URP1000/32 W

URP1000/34 W

Coating Warranty

Cladding material	Coating warranty period
Colorcoat HPS200 Ultra®	Up to 40 years
Leathergrain Platisol	Up to 30 years
Colourcoat Prisma®	Up to 40 years

System Warranty

Gemello® system	System warranty period	Fixing type
Gemello® 30	30 years	A4 (316) Stainless steel
Gemello® 25	25 years	A2 (304) Stainless steel
Gemello® 12	12 years	Carbon steel

A4 (316) Stainless steel fixings for coastal locations.

Gemello® Warranty references consist of both the system and external coating warranty periods. i.e. Gemello® 25/30: 25 year system warranty, up to 30 year material coating warranty.

U Values – Roof & Wall Systems

U W/m²K	λ0.040 W/mK Net insulation depth mm
0.34	140
0.30	140
0.26	160
0.25	180
0.24	180
0.23	200
0.22	200
0.21	200
0.20	220
0.19	220
0.18	240
0.16	260
0.15	280
0.14	300
0.13	340
0.12	380
0.11	400

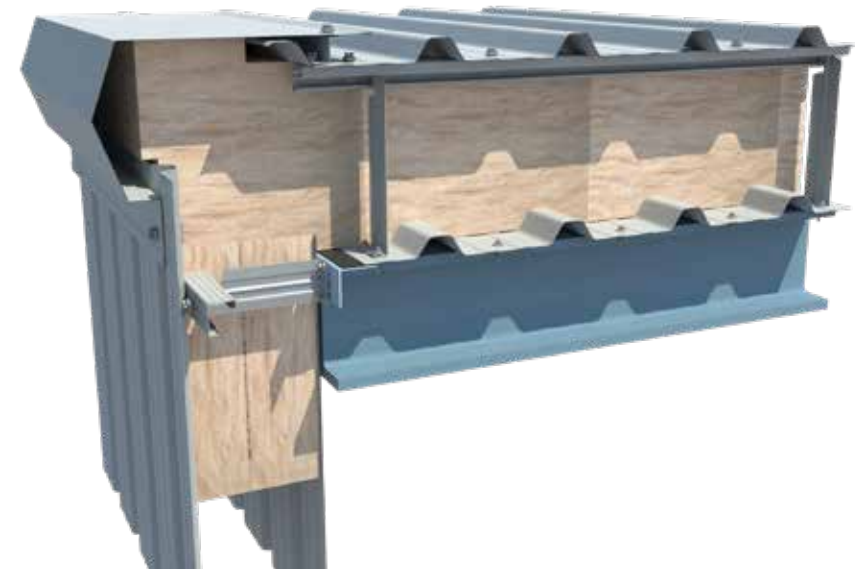

U Value Notes: Spacer depth = net insulation depth. These tables are indicative only. Please contact the technical team for scenario specific information.



SIG Building Solutions

Warnell,
Welton,
Carlisle,
Cumbria
CA5 7HH

T: 01697 477590

E: sales@sigbuildingsolutions.co.uk

©Building Solutions (National) Ltd.
Gemello® is a trademark of Building Solutions (National) Limited.

Colorcoat, Colorcoat HPS200 Ultra, Colorcoat Prisma are trademarks of
Tata Steel UK Limited.

The information given in this guide shall be regarded as accurate at the time of going to print and may be subject to change thereafter. Building Solutions (National) Limited reserves the right to alter or delete any product and/or technical specification featured in this guide without prior notice. Images provided are for illustration purposes only and do not represent the scope of supply.

Issue 2 - 07/2024 / SK

Gemello® Warrantied Twin-Skin Cladding System

www.sigbuildingsolutions.co.uk